

PROJECT NAME

REVISED KITCHEN
3-8-10
FINAL PLOT
3-15-10

DATE: 1-11-09

REVISIONS:

ISSUED FOR FINAL
REVIEW 2-15-09
ISSUED FOR PERMIT
2-24-09

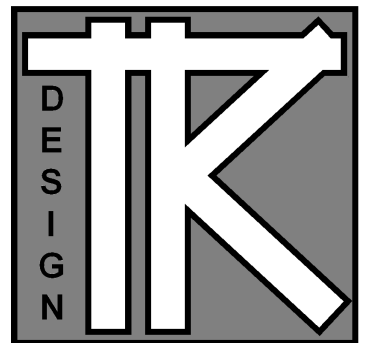

TODD KNUTSON DESIGN

40 SOUTH 7th STREET
STUDIO 212-156
MINNEAPOLIS, MN. 55402
P: 612-251-1041
F: 612-552-4119
WWW.TODDKNUTSONDESIGN.COM

TERMS:

CONTRACTOR TO VERIFY ALL DIMENSIONS, AS BUILT CONDITIONS (IF APPLY) AND SITE CONDITIONS, BEFORE ORDERING MATERIAL OR DEMOLISHING EXISTING STRUCTURES. CONTRACTOR AND ALL SUBS MUST REPORT ANY DISCREPANCIES TO DESIGNER IMMEDIATELY, AS BUILT AND SITE CONDITIONS OFTEN HAVE UNIQUE CONDITIONS THAT CANNOT BE PREDICTED OR FORSEEN AT DESIGN COMPLETION. CONTRACTOR, SUBS AND DESIGNER WILL WORK TOGETHER TO REACH A SOLUTION IF ANY SITUATION MAY ARISE.

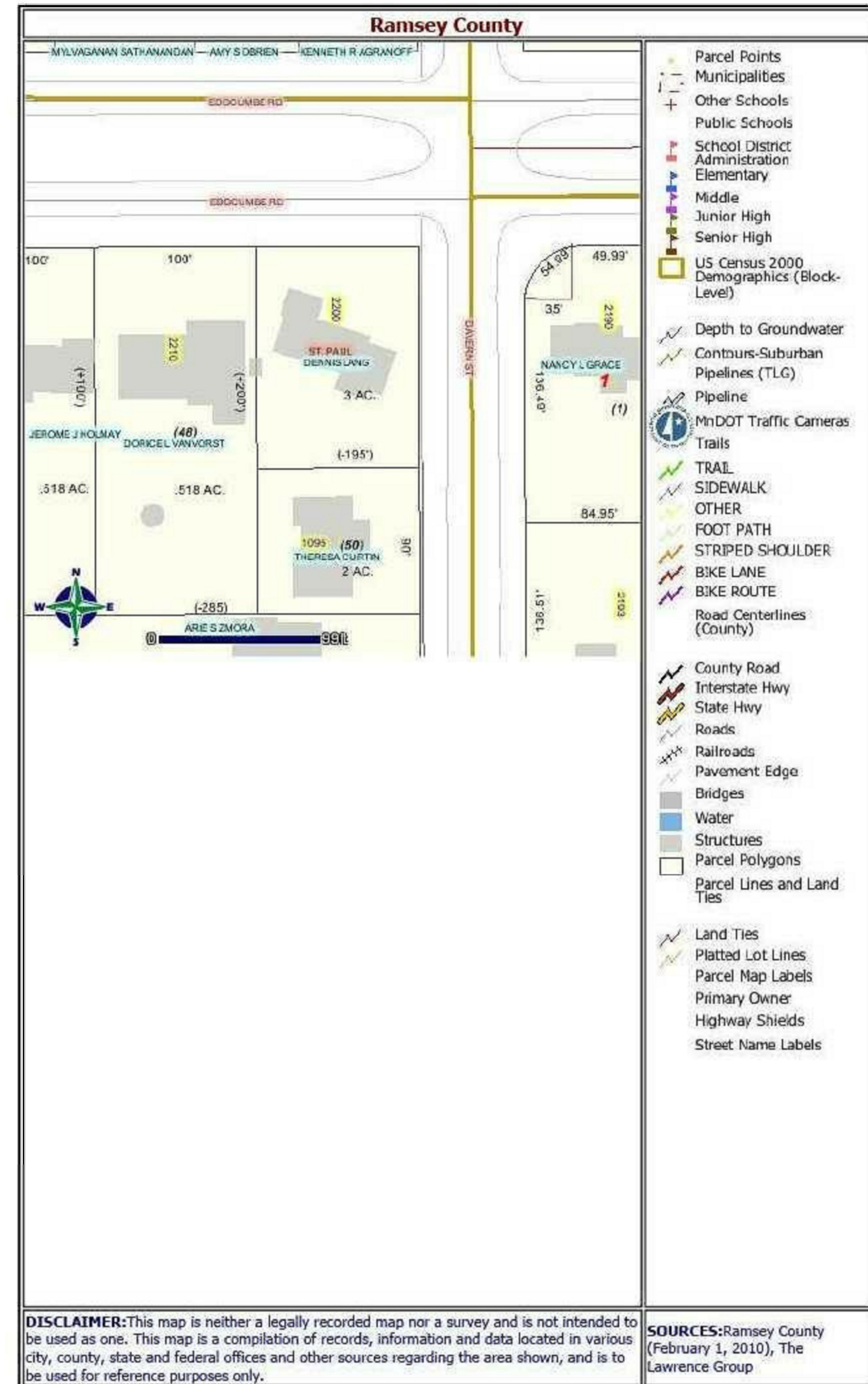
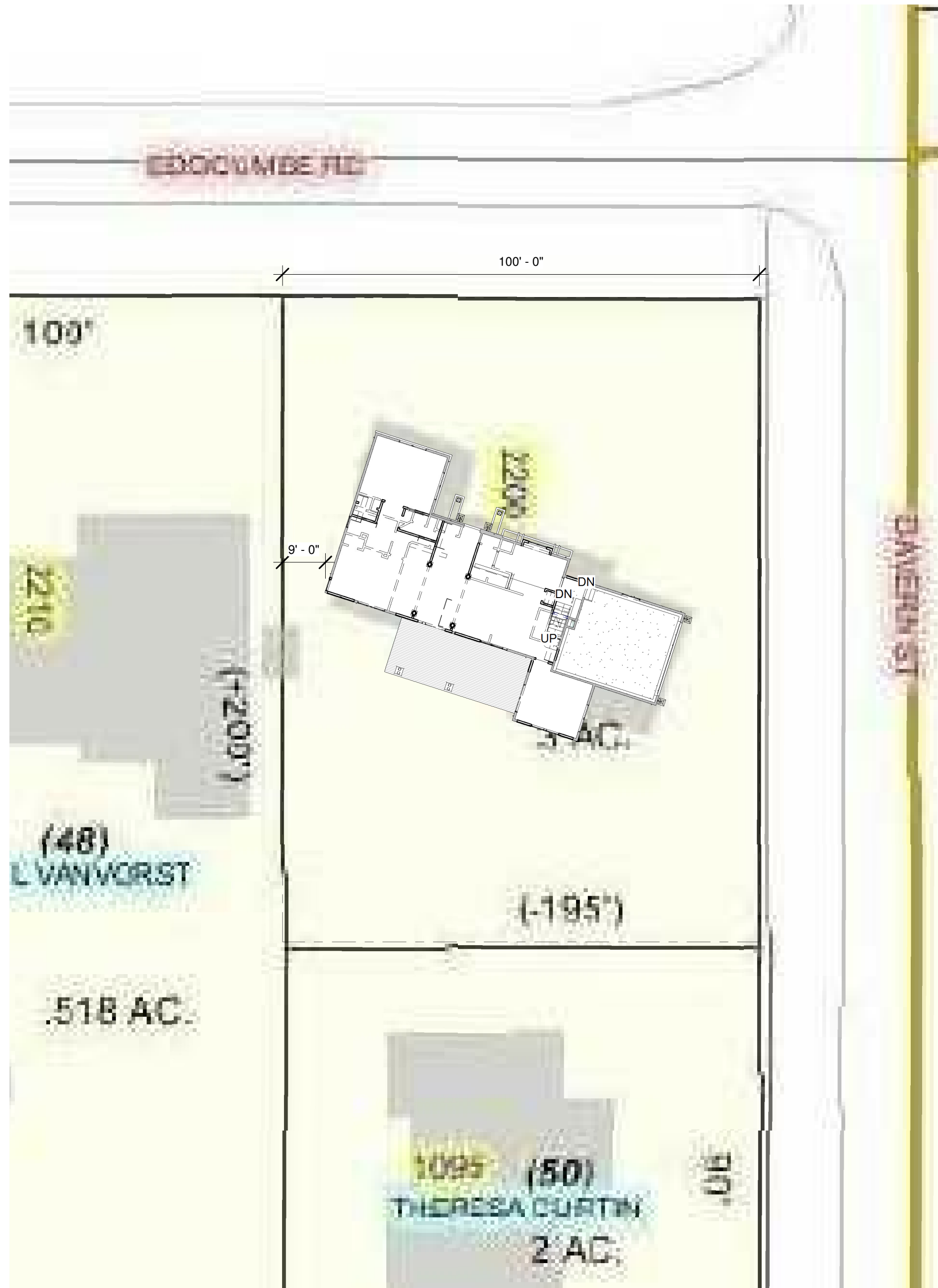

DISCLAIMER: This map is neither a legally recorded map nor a survey and is not intended to be used as one. This map is a compilation of records, information and data located in various city, county, state and federal offices and other sources regarding the area shown, and is to be used for reference purposes only.

SOURCES: Ramsey County (February 1, 2010), The Lawrence Group

1 Site
T 1" = 20'-0"

2200 EDGCOMBE

JOB NO: 2200

SHEET NO:
T
TITLE